

Reaching Out



St. Joseph's Auxiliary Hospital
FALL 2003

10707-29 Avenue Edmonton, AB T6J 6W1
Tel: (780) 430-9110 Web: www.stjosephs.ab.ca

Message from the Board Chair

I welcome this opportunity to let our community know about the vital work done by the hundreds of staff and volunteers who provide care and services to residents of St. Joseph's Auxiliary Hospital. I have been associated with St. Joseph's since childhood – my father, a physician, visited residents at the old Whyte Avenue site on a daily basis. From those early years, I knew the important role our community plays in providing quality care to those in need of our services. St. Joseph's has in excess of 200 regular volunteers - many from our immediate neighbourhood. Volunteers contribute thousands of hours over the course of the year assisting with program delivery, befriending residents, working on special projects or providing leadership as a volunteer with our Board of Directors. Whether paid staff or volunteer, the commitment of those associated with St. Joseph's Auxiliary Hospital is clear. We have the desire to make a positive difference in the lives of those who require continuing care. If you can spare a few hours a week, please contact our Volunteer Coordinator to discuss opportunities to share your time and talent.

Tim O'Brien, Chair, Board of Directors

Mission Statement

We believe...

In living the Gospel values which inspire the Sister of Providence of St. Vincent de Paul and in continuing their ministry of compassionate care to people of all cultures and beliefs.

We serve...

People who require community support, continuing care or palliative care.

We provide...

A broad spectrum of programs and services focusing on health and wellness and incorporating the unique qualities and capabilities of each individual.

We commit...

To provide quality care with compassion in the Christian tradition.

Message from the Executive Director

Giving....this has been the focus of care at St. Joseph's Auxiliary Hospital since 1927. In the multitude of changes that have occurred over the years, the provision of "quality care with compassion in the Christian tradition", has remained a constant.

We give of time, talent and resources to provide physical, psychological, social and spiritual care to the most frail among us; people requiring nursing and rehabilitation services aimed at improving their health status while living with chronic medical conditions.

Our distinctiveness, however, is in our mission as a provider of Catholic healthcare. Our staff strives to provide "compassionate caring" coupled with the professional skills needed to make a difference in the lives of the people we serve.

We appreciate the community's generosity that enables us to continue the work of St. Joseph's Auxiliary Hospital. Our finite resources are augmented by people who give - people like you who support and give so that others might be blessed to live a life with dignity and respect. Thank you for being a part of the work at St. Joseph's Auxiliary Hospital.

Marilyn Snow, Executive Director

BOARD OF DIRECTORS

Tim O'Brien, Chair
Tony Holloway, Vice Chair
Jean Bara
Lynne Duncan
Eileen Filthaut
Jack Kane, Q.C.
Mary Pat Skene
Chris Ashdown
Peter Yaremchuk
Dr. Robert Bradstock

SENIOR MANAGEMENT

Marilyn Snow,
Executive Director
Alice Sears,
Director of Care
Ray Lister,
Director of Human Resources
Debra Frederick,
Director of Communications
Rob Kinsman,
Director of Support Services
Trevor Koot,
Director of Fund Development

How YOU Have Helped Us Grow...

OUR DONORS' DOLLARS HARD AT WORK

With donations we are able to fulfill the needs of the Hospital as they are identified by the staff and Board of Directors. Each year the donations from the previous year are used to purchase equipment, provide staff education, and/or contribute to program maintenance and expansion, wherever the need may be. For example, donations received during the 2002/2003 fiscal year contributed to the purchase of a pulse oximeter, which is used to determine oxygen levels in the blood, an electronic blood pressure monitor, a recumbent bike for physiotherapy and two portable oxygen delivery systems.

In the ever-changing world of health care and with almost daily advancements in technology, staff education is vital. Your donations have helped the staff of St. Joseph's maintain current knowledge of trends in the health care field.

At any given time, four days a week, there is a good chance you will be greeted by the friendly face of our golden retriever, Bailey. Bailey is only one of the many animals that make up the pet therapy program at St. Joseph's. As well, every Wednesday, an afternoon tea is hosted in Palliative Hospice Care to give patients and their families an opportunity to visit. These are but a few examples of programs made possible through donors' support.

RESIDENT STORY

Water therapy isn't for everyone but Dr. Walter Gainer certainly looks forward to the weekly swim program at St. Joseph's. The warm circulating water and attention of trained volunteers and staff ensure residents receive maximum therapeutic benefit from the sessions. Dr. Gainer's personal calendar is full – he and his wife make sure to pencil in entertainment programs – especially country music and he's a regular participant in the Reach for the Top competition with other continuing care centres.

St. Joseph's residents were at the top of their game last year having secured first place in the regional competition and they fully expect to repeat their success this year. In his working life Dr. Gainer was a professor of economics, logically, he enjoys the opportunity to challenge his memory and analytical skills. When not engaged in intellectual competitions, Dr. Gainer takes advantage of the opportunity to attend theatre events, lake trips and shopping excursions. Chatting with Walter over a cup of coffee, he said that recreation activities are a great change from the regular routine and values the stimulating and well organized calendar of events.

A DONOR'S STORY

A grocery store on the prairies was a far cry from the forestry career in Boistown, New Brunswick that Tubby Bateman had come to know when his family decided to move in 1914. Opening his first grocery store in 1932 was just one of his many great achievements that contributed to his involvement and passion for the community.

Upon sitting down with the late Mr. Bateman's daughter, Mary Agnes Radostits, to discuss the family's love of philanthropy and their charitable giving to St. Joseph's Hospital, I was filled with an overwhelming sense of what it truly means to give. The Bateman and Radostits family-owned IGA grocery stores in Edmonton and area are currently in the third generation of ownership. All of Verda and Tubby's children and grandchildren remain steadfast to their belief of giving back to the community that supports them.

Upon establishing the Verda & W.C. (Tubby) Bateman Foundation, the decision to make St. Joseph's Hospital a charity of choice was an easy one for the Bateman family, "St. Joe's has always been a favorite", says Mary Agnes. The relationship between St. Joseph's and the Bateman family began back in the early 1950s when Mrs. Bateman would visit the residents of St. Joseph's Hospital on 82nd Avenue and invite the Sisters from the Hospital for get-togethers at the Bateman home or lake cottage. Mary Agnes' grandmother, uncle and mother were all residents at St. Joseph's and are remembered by many staff who cared for them. In speaking of the care her mother received, Mary Agnes says, "Sister Benilda was her guardian angel while she was here".

The Bateman Family Foundation has made a significant impact on St. Joseph's through their financial gifts. They have established the Bateman Staff Mission Award which recognizes, by way of peer nomination, those employees who live the mission of St. Joseph's on a daily basis – To Provide Quality Care with Compassion in the Christian Tradition. As well, by making a major financial donation to the proposed St. Joseph's Hospital's All-Season Conservatory project, the Bateman Family Foundation has demonstrated their support of enhancing the quality of life for the residents and patients.

This is just one example of the support we receive on a daily basis and are truly grateful to have friends in the community such as the Bateman family. We thank all those that have supported us through our seventy-six years of service in Edmonton, and look forward to providing "quality care with compassion" for years to come.

STAFF STORY

Barb Beebe has worked at St. Joseph's for thirty-three years. Barb is responsible for purchasing new equipment and in this photo, she is demonstrating the features of the newest technology, a digital blood pressure machine, to nursing staff. Purchased with funds from donations, the machine allows staff to record blood pressure in less time and with more accuracy than the older models. Speaking about her career at St. Joseph's, Barb believes that the family atmosphere of the hospital, the opportunity for internal advancement, ongoing training and recognition of a job well done are what has kept

her at St. Joseph's. She hopes to retire from St. Joseph's in a few years although from the input of those who work with her, it's doubtful that we could get along without her – some people work into their eighties don't they?



Testing our new blood pressure monitor (L to R) Patricia Kostkowski, Barb Beebe, Debbie Papanikolaou

SEVENTY-FIFTH ANNIVERSARY

We've certainly accomplished a great deal in our first seventy-five years! Founded in 1927 by the Sisters of Providence of St. Vincent de Paul (Kingston), St. Joseph's Auxiliary Hospital was Edmonton's first home for aging pioneers. Originally located on Whyte Avenue, we relocated to our new facility in the Ermineskin community in 1993.



Hospital Auxiliary members serving 'high tea' to guests

Programs and services changed over the decades to meet emerging needs and continue to do so today as we operate specialized programs such as Palliative Hospice and Peritoneal Dialysis Programs. 2002 was a busy year as we planned our 75th Anniversary celebrations. The creation of a commemorative book highlighting the contributions of people who embody the spirit of our organization was truly a labour of love. The editorial committee spent eighteen months researching the details of our first 75 years. In so doing, we rekindled old friendships and made many new friends through our anniversary events. We are grateful to everyone who found time to help organize and attend the events that celebrated the people, who, through their generosity, compassion and dedication, formed the organization that today is St. Joseph's Auxiliary Hospital.

2003 DINNER AND AUCTION

In partnership with the Rotary Club of Edmonton South, St. Joseph's was proud to co-host our seventh annual Dinner and Auction. This black tie evening provided an exquisite dinner and the excitement of both a live and silent auction like no other in Edmonton.

We are happy to announce that for the second year in a row, the Dinner and Auction raised approximately \$60,000, which will support the upcoming Ambulance Bay/Conservatory

project highlighted on page six of this newsletter.

St. Joseph's is very fortunate to have friends and neighbours in the community such as the Rotary Club of Edmonton South who, year after year, commit endless amounts of time and energy to ensure the success of the Dinner and Auction. It is with Rotary's continued support that this event will provide awareness of St. Joseph's mission as well as financial support well into the future.

A FORTIETH ANNIVERSARY

It is rare to remain with the same employer for forty years – even rarer to love every day of your career but Sr. Mary Benilda is an energetic example of passion on the job. Having become a Sister of Providence more than 60 years ago, she managed to find time throughout the years to follow football – particularly football as played by the Winnipeg Blue Bombers. On the occasion of her 40th Anniversary with St. Joseph's Auxiliary Hospital, she was presented with a signed Blue Bombers jersey and tickets for the October 17th game against the Eskimos. Sister Benilda's enthusiasm for sport and people is an example to all of us. Congratulations on achieving this milestone anniversary Sister Benilda!

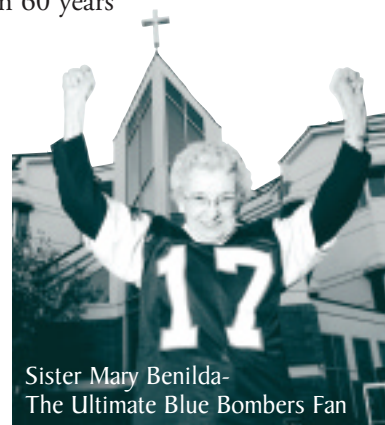

Sister Mary Benilda-
The Ultimate Blue Bombers Fan

We Would Like to Hear from You

St. Joseph's Auxiliary Hospital
10707 – 29th Ave. Edmonton, AB T6J 6W1

www.stjosephs.ab.ca

Tel: (780) 430-9110

Fax: (780) 430-9777

IDENTIFYING THE NEED

Each year, the Board of Directors of St. Joseph's Hospital is presented with a list of needs compiled by staff. These needs are assessed and the board determines the source of funding used to fulfill each need as they are approved. The board approves programs, equipment and projects to be funded by donations. It is then the goal of the Fund Development Office to secure outside funding and support for these projects. Should one of these initiatives be of interest to you or your company, please contact Trevor Koot, Director of Fund Development at 430-3430 to receive more information on how you can contribute.

A degree of "clinical atmosphere" in a hospital, whether it be long-term or acute care, is inevitable. We have a vision at St. Joseph's that all components contributing to a clinical setting will be altered to give the facility an "at home" feeling. The dining rooms, hallways, and bedrooms on each floor will be decorated to give these living areas a more comfortable, cozy feeling. Taking a bath has always been considered

relaxing and soothing; as such, it should be a special experience each and every time. For this reason, we will endeavor to transform each of the twelve bathing areas into individual mini-spas. With greenery, scents, music, and mist, the residents will be greeted by an 'Eden' to call their own each time they bathe.

By maintaining a focus on staff and resident safety, the hospital has identified the need to outfit the facility with low-style beds, which sufficiently lower to the floor so as to improve ease of access in and out of bed as well as significantly reduce the risk of injury, should a fall occur. This proposed initiative is forecast to take five years, replacing forty beds each year for a total of 200 beds by 2008.

With the inevitable direct benefit these projects will bring to the residents, we are all very excited to see them brought to fruition and thus, once again, improve the quality of care our residents receive each and every day.

ALL-SEASON CONSERVATORY/AMBULANCE BAY EXPANSION: A CAPITAL PROJECT

As a 204 bed continuing care facility, the residents of St. Joseph's call the hospital home year round. In addition, living in a diverse climate where the winter season can last as long as seven months, the residents of St. Joseph's tend to remain indoors. Thus the need has been identified to have a tropical environment that can be accessed year round. This all-season conservatory will be a serene oasis that will provide residents and families with a therapeutic atmosphere by way of audio, visual, and aromatic stimuli.

In coordination with the development of an all-season conservatory, expansion to the current ambulance bay has also been proposed. Our current ambulance bay was designed in the early 1990's to accommodate emergency and Disabled Adult Transportation System (DATS) vehicles.

Since that time, emergency vehicles have grown in size and the current space cannot accommodate these newer vehicles. In 1997 St. Joseph's successfully raised funds to purchase a wheelchair coach for residents, which is too large to access the existing ambulance bay. It is parked outdoors which requires considerable labour to clean snow and warm the vehicle before it can be used by residents. The addition of a second bay and enlargement of the original bay will enable the residents' coach to be sheltered and provide access for all emergency and DATS vehicles.

For more information on this project or to tour the proposed location for the conservatory and ambulance bay expansion, please contact Trevor Koot, Director of Fund Development at 430-3430 or trevork@stjosephs.ab.ca.

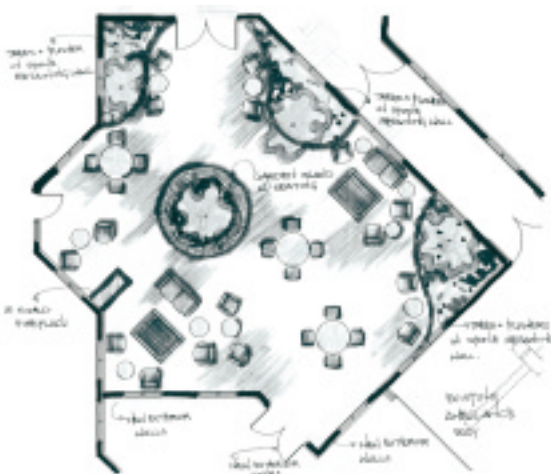

For concept purposes, this is a superimposed image of a solarium in the proposed future location of St. Joseph's All-Season conservatory.

Building Community Support

ST. JOSEPH'S VALUES THE COMMUNITY IT HAS SERVED FOR SEVENTY-SIX YEARS

Since the beginning when the Sisters of Providence would set out on "exhausting begging tours" to raise money which was put toward continuing the mission, the staff, volunteers, board and families have been sharing the story of St. Joseph's.

What sets St. Joseph's Auxiliary Hospital apart from other continuing care facilities in Edmonton? What story has been shared for seventy-six years that compels people to give?

The story of St. Joseph's must be heard as a whole to fully appreciate what differentiates this facility from other continuing care facilities in Edmonton. There are many care facilities (some faith-based), there are Palliative Hospice Programs, there are Community Day Support Programs and there is access to Peritoneal Dialysis in the region; the fact that St. Joseph's Hospital offers all of these programs and services under one roof is a reality that sets us apart.

While offering programs and services to people of all faiths, cultures, ages, abilities and interests, the staff of St. Joseph's remains mission-focused and steadfast to addressing all the needs of those we serve, be it spiritual, physical, mental or emotional. Through its mission, St. Joseph's is focused not only on maintaining, but improving, quality of life.

St. Joseph's offers a Continuing Care Program second-to-none, which focuses on meeting individual needs, promoting independence and restoring health and well-being to the greatest extent possible.

As a center of expertise for Huntington Disease, St. Joseph's specializes in meeting the unique needs of clients with Huntington Disease by providing trained staff and an environment that supports independence for HD clients. In 1996, St. Joseph's was proud to bridge the transition between

community and continuing care by welcoming the Huntington's Resource Centre to the Hospital.

St. Joseph's customized Palliative Hospice Program incorporates our strong mission and values into services that are compassionate and ethically based while meeting the holistic needs of palliative care patients and their families. Palliative Hospice Care is a unique program that enables terminally ill patients to access care in a supportive environment that focuses on maintaining quality of life and personal comfort.

Our Community Day Support Program offers Nursing Services, Occupational, Physical and Recreation Therapy in a bright, cheerful environment. Operating Monday through Friday, the program is open to adults with rehabilitation needs.

Residents requiring Peritoneal Dialysis and who are unable to reside at home, receive treatment at St. Joseph's in our seven bed program. Working in collaboration with the Northern Alberta Renal Program at the University of Alberta Hospital, Home Peritoneal Dialysis Unit and the Capital Health Authority Central Assessment and Placement Services, St. Joseph's is able to provide specialized care within an environment that promotes independence as well as client and family involvement.

For seventy-six years, St. Joseph's has been proud to share its story of commitment and contribution to the community in an effort to improve quality of life. It is truly with great pride and blessing that we are able to continue offering these unique and innovative programs and services to those that require continuing care.



THE NEW FUND DEVELOPMENT PROGRAM

In an effort to uphold the high quality of care that St. Joseph's Hospital has been able to provide its residents since 1927, a formalized Fund Development Program has been initiated. The goal of this program is to supplement the current funding St. Joseph's receives from government sources, with much needed support from our friends and neighbours in the community.

St. Joseph's has been the recipient of an overwhelming amount of community support of both a monetary and non-monetary nature throughout its years in Edmonton. We thank all those who have contributed to helping St. Joseph's uphold the mission and values we live by each and every day.

By instituting the Fund Development Program, we will not forget those individuals, families, businesses and community groups that helped us get to this point, but rather, build on this base of support to ensure we continue to serve our community to the best of our ability.

St. Joseph's is proud to offer a comprehensive Fund Development Program which gives the donor an opportunity to choose the method of giving a gift that best suits their needs. **To receive more information regarding donor options, please contact Trevor Koot, Director of Fund Development at 430-3430 or trevork@stjosephs.ab.ca.**

Donor Recognition

THE TREE OF LIFE

The search to find a creative way to acknowledge donations made to St. Joseph's became a reality in 1997, our seventieth anniversary year, in the form of a tree that celebrates both life and giving. Metal leaves on the tree reflect natural earth tones of Gold, Burgundy, Copper and Green. As the leaves are added, the colours complement the tree, made of butternut wood, to reflect the richness of colour and design seen in nature.

As donor names are added to one of the four leaf categories, a metal leaf will "grow" on the sculpture. Each leaf acknowledges an individual gift within a particular category or level of donation.

OUR DONOR CATEGORIES ARE:

GOLD LEAF: Benefactor	Gifts of \$10,000 or more
BURGUNDY LEAF: Patron	Gifts between \$2500 and \$9999
COPPER LEAF: Sponsor	Gifts between \$1000 and \$2499
GREEN LEAF: Supporter	Gifts between \$250 and \$999

Names of donors within each leaf category are listed on the oak base unit.

OAK BASE BOOK: Friends	Gifts under \$250
-------------------------------	-------------------

The book also contains names of donors who provide gifts-in-kind or future (deferred) gifts

GOLD LEAF (BENEFACTOR)

4th Degree Knights of Columbus (St Joseph's Assembly)	Marple, Julliette
Al Shamal Edmonton Shriners	McBeth-Lawson, Marlaine
Alberta Knights of Columbus	O'Neill O'Neill Procinsky Architects Ltd.
Canada Safeway Limited	Oleksy & Co.
Dubetz Family	Parsons, Morris
Janus, Norma	Pet City
Koziak Family Foundation	Porter, P.H.
Rotary Club of Edmonton South	Pugh, Ross
Rotary Club of South Edmonton Charitable Trust Fund	Roche, Douglas
Smith, Hilda	Sheptycki, Anna
St. Joseph's Hospital Auxiliary	Sisters of Providence of St. Vincent de Paul (Kingston)
Stevens, Werner & Margaret	Snow, Marilyn
The Alger Foundation	United Way of the Alberta Capital Region
The Stollery Charitable Foundation	Western Health Planning Associates Ltd.
The Verda & W.C. (Tubby) Bateman Foundation	Wong, Stanley
Weyerhaeuser	
Wild Rose Foundation	
Young, Irma & John E.	

COPPER (SPONSOR)

Amerongen, Gerard
Benedetto, Joseph
Boer, Jim
Canadian Foresters Edmonton
Carry, Roger
Chernyk, Vickie
Connelly, McKinley Ltd.
Cunningham, Pauline E.
Derbawka, Sophie
Downs, Sharon
Dzanik, Vadimir
Ellis, John S.
Faulkner, Jean
Fedoriw, Leo & Roman
Gahr, Helen
Gauld, Ivan & Marian
Grace, Harry
Haag, Lydia
Hertz, M J

Herunter W.
Holloway, Deborah
Holy Family Columbus Club
Hrynew, Margaret
Hubbard, Peter & Sue
Justik Medical Clinic
K-Bro Linen Sytems Inc.
Kieser, Leonard & Sharon
King, Kenneth & Patricia
Knights of Columbus Father Bonner Council
Knights of Columbus Edmonton Council
Knights of Columbus Holy Family Council
Knights of Columbus Nazareno Council
Knights of Columbus Our Lady of Fatima Council
Koziak, Emily
Lavender, Lyle & Mary
Lewis, Kenneth & Joanne
Maguire, M.
Marsh, Jane
Maskeiw, Catherine
Matheson, Donald & Heather
McCoy, Helen
McCoy, Terry & Pat
Meekism, Patricia
Melnyk, Demitio
Mitchell, Douglas
Murphy, Virginia
Murry, Ken
Northern Alberta Prosthetic & Orthotics Service
Norville, Evelyn
Park Memorial Limited
Pennett, Joseph
Pintkowski, Ed & Dolores

Plunkett, John & Georgina
Potter, G.A.
Radostits, Ivan & Mary Agnes
Reese, Douglas & Heather
Roche, Francis
Royal Canadian Legion Ladies Auxiliary #150
Sartoris, Paul
Sass, Lillian
Schafer, Dorothy & Lloyd
Simonar, David & Laurie
Simpson, Sydney
Smith, Deane H.
Smith, Gretta
So, Michael
Steele, James. W. & Pauline
Sturgess, Heather
Tchong, Josephine
The Alberta Knights of Columbus Foundation
Tidswell, Mary
United Way of Calgary Donor Choice Program
Vance, R.L.
Walker, Elisabeth
Wilman Financial Inc.
Wu, Miriam
Young, George & Mecredi

GREEN LEAF (SUPPORTER)

625848 Alberta Ltd. O/A 7th Ave Liquors
Albus, Zenta
Allied Brake & Clutch Ltd.
Alsager, Marie
Anderson, William J
Anonymous
Awid, Mike & June
Ball, Geoff & Catherine
Baxter, Ruth S.

Beck, George	Fraternal Order of Eagles G.C. Consol.	Ma, Y.S.	Sabo, Andrew & Gail
Bedard, Dennis	Frederick, D.L.	Machnik Family	Schaff, Lorraine
Benilda, Mary	Gagne, Gerard	Maclean, Lloyd & Marilyn	Schetzsl, Susan
Biollo, Family Peter	Gainer, Brenda	Manulife Financial	Schoettler, Richard & Nellie
Brese, William & Rita	Gates, George	McAthey, Gordon R. McClean Arthur	Selte, Dorothea (Estate of)
Brosseau Holdings Ltd.	Gunsch, Erwin	McDermott, Frank & Alma	Seutter, Norman & Judy
Budget Rent-a-Car of Edmonton Ltd.	Guzak, Robert & Sharon	McNaughton, Margaret	Shave, Muriel & Duane
Campbell, Madeline (Estate of)	Habib, Naiyer	Meier, Twila	Sherman, Esther
Campbell, Raymond & Rosa	Hartling, Lisa A	Miller, Glory & Greg	Simpkin, Howard & Jo-Ann
Caouette, Alice	Haweriak	Miller, Margaret	Sisters of Charity of St.Vincent de Paul (Halifax)
Carlson Body Shop Supply	Hunka, M.V.	Minion, Marion	Skibin, June
Caspar, Antje	Hunt, David & Hiliary	Mohler, Gerald	Smith, B.A.
Chan, Yee Sok Chun & May Wah	Inland Restaurants Ltd.	Monson, Marilyn	Smith, Jessie
Chapple, Rose	Jones, Cecile	Morris, Gertrude	Sofronuik, Margery (Estate of)
Cherneski, Helen	Jones, W. J. & Leila	Mynio, Nick	Soriano, Regina
Christenson, Elvin	Kadis, E.M.	Nahirniak, Darryl & Kathy	Stangen's Limited
Christy, Hana & Brian	Keil, James F & L. Valorie	Navis, G.W.	Steele, J. H.
Chrzanowski, Zbigniew	Keldsen, Richard	Nay, Pauline	Stein, Richard & Marie
Chu, Katy	Key, Daniel G. & Iva M.	Nazareno Columbus Charity Club of Edmonton	Stott, Bob
Church, Ellen	Kinley, Marie	Ng, John & Margaret	Taylor, Susan
Cook, Edwin & Patricia	Knowler, A. S. (Bert)	Nixon, Wayne & Alice	TELUS Employees Charitable Trust Heart
Cook, Nellie	Krywolt, Vlasta	O'Brien, Albert D.	Triscott, James & Jean
Corsbie, Bert & Rose	Kufeld, Enzien	O'Driscoll, Don	Tse, Kim Yin
Costley, Mary George	Kuhn, Beatrice	O'Neill, Patrick	Uhlich, Henriette
Craig, Shirley	Labatt Breweries of Canada	Oldenburg, Clifford	Villeneuve, Jacqueline
Dairyworld Foods	Langager Insurance Brokerage Inc.	Overman, Marilyn	Wareing, Fred
Dennis, Loys	Lapchuk, William	Pagett, David	Warke, John & Mary
Desjardins, Dave & Diane	Lau, King Leung	Pang, Peter & Rosemary	West, Stefanie
Dey, Hilda	Lee, Clemens	Patterson, Dalbert	Whiteside, Betty
Dobson, Miriam	Lefebvre, Frances	Pinkoski, Ray & Lenora	Williams, Pat
Dunford, Doreen	Lehmann, B. & I.	Pollack, Shoshana	Wilman Financial Inc.
Earle, J.P. & M.E.	Lehmann, Ilse	Prochnau, Arnold & Becky	Wilson, Joe
Edmonton Gyrette Club	Leonard, John	Rampling, Verna	Wirun, Norman
Eggen, Clara C	Li, Yiu-Sing & Yung Fong	Redner, Lela	Wong, Lily A.
Ettrich, Anna	Litwin, John & Linda	Rinzema, Michael & Claudia	Wong, Margaret E
Findlay, Grace	Loh, Andrew	Robinson, Jane	Yiu, K.C.
Findlay, Robert	Lotus Painting Ltd.	Roed, Delores	Yurkiw, Hellena
Fong, Richard A	Loyd, Cathy	Roneil Ventures Ltd.	Ziarko, Ben
Forbes, Mungo	Lynn Fynn Holdings Ltd.	Roppo, Yvonne	
Ford, George & Louise	Plaisier, Stan	Ryan, Maureen	

Our Accountability To You

At St. Joseph's Hospital we continually endeavor to provide donors with as much information as we can about our fiscal management and responsibility involving donations. Below you will find a summary of the source of donations for our last fiscal year and articles throughout this newsletter identify how these donations have or will be utilized.

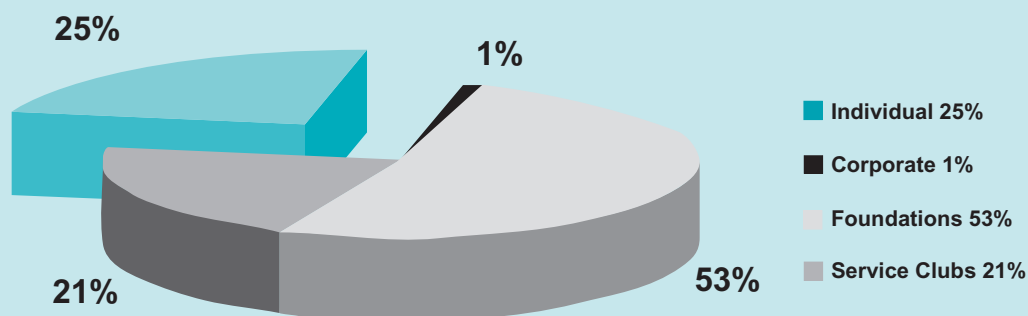

We Value Your Input

To ensure that our services meet the community's needs and expectations, we would like to hear from you. Please respond to all questions that apply or are of interest and return this tear-off portion of the newsletter to:

St. Joseph's Auxiliary Hospital 10707-29 Avenue, Edmonton AB T6J 6W1

Please complete the address portion of the donation form at the bottom of this page if you would like us to reply to your responses.

PROGRAMS:	YES	NO
I have had a loved one reside at St. Joseph's	_____	_____
I would like more information about the Continuing Care Program	_____	_____
I would like more information about the Palliative Hospice Program	_____	_____
I would like more information about the CAPD Program	_____	_____
I would like more information about the Community Day Support Program	_____	_____
I would like more information about the Huntington Disease Program	_____	_____
I would like to continue to receive St. Joseph's newsletter	_____	_____
I have visited St. Joseph's website at www.stjosephs.ab.ca	_____	_____

FUNDRAISING:	YES	NO
I have provided a gift to St. Joseph's Hospital in the past	_____	_____
I would like more information on St. Joseph's donation program	_____	_____
I would like more information about one of the projects outlined in this newsletter (please specify) _____	_____	_____
I have remembered St. Joseph's Hospital in my will	_____	_____
I would like to learn more about how to leave a legacy gift for the benefit of the residents of St. Joseph's (e.g. annuities, real estate, bequests, endowments)	_____	_____

Donation Form

St. Joseph's Auxiliary Hospital is a registered charitable organization. Receipts, for tax purposes, are issued for all donations. Charitable registration # 119183614RR0001

I am enclosing my gift in the amount of \$ _____ (Please do not send cash through the mail).

Please use this donation for the most urgent need

I prefer to direct my donation to the following (please identify): _____

Your Name (please print): _____

Address: _____ City: _____

Province: _____ Postal Code: _____ Phone: _____

Please detach and mail to:

St. Joseph's Auxiliary Hospital
10707-29 Avenue, Edmonton, Alberta T6J 6W1